

| MAP | BRIDGE # | TREATMENT |
|---------------|----------|------------------------------------|
| #2 (SR 1169) | #431 | SEAL |
| #3 (SR 1312) | #380 | DO NOT SEAL |
| #9 (SR 1506) | #112 | DO NOT SEAL |
| #33 (SR 1130) | #341 | DO NOT SEAL - TIE IN AT CONST. JT. |
| #36 (SR 1127) | #252 | SEAL |

CHATHAM COUNTY

TIME: 10:00 AM
 DATE: 11/15/19
 BY: J. HARRIS
 CHECKED: J. HARRIS
 APPROVED: J. HARRIS
 PROJECT: CHATHAM COUNTY
 SHEET: 1 OF 1

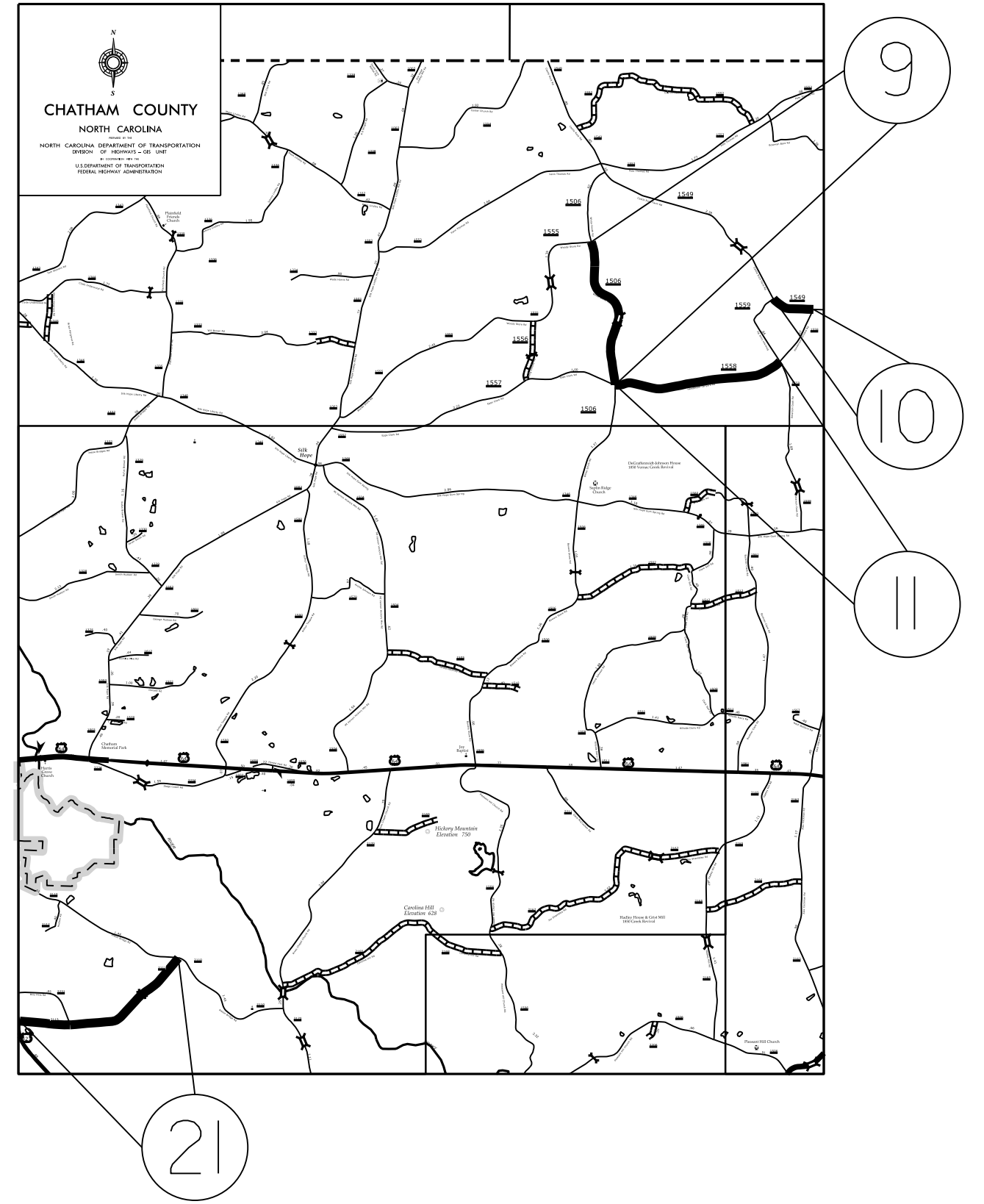
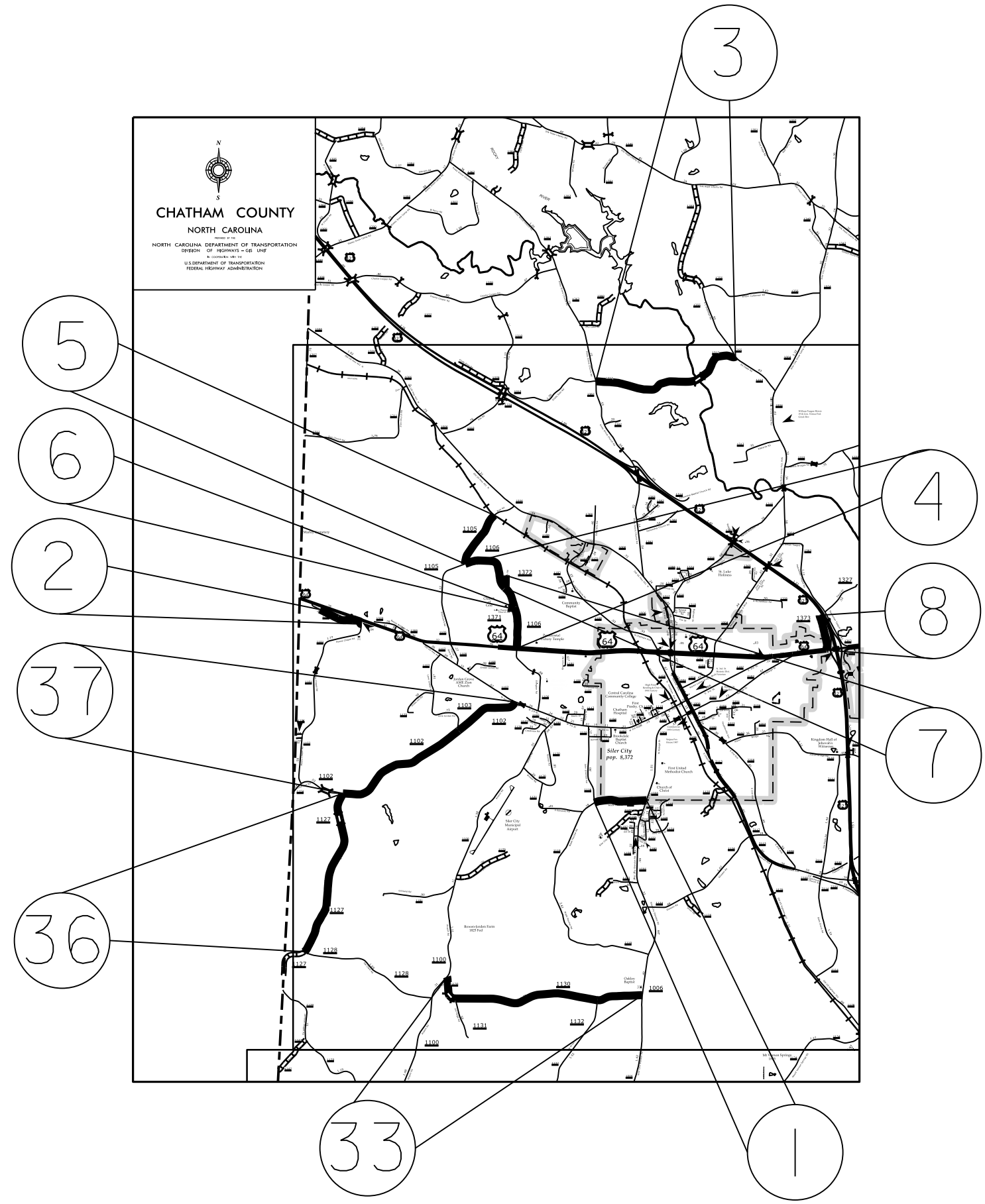

DATE: 08/20/19
TIME: 10:00 AM
BY: JAC
CHECKED BY: JAC
SCALE: AS SHOWN
PROJECT: 8SP.20194.15
SHEET: 2 OF 2

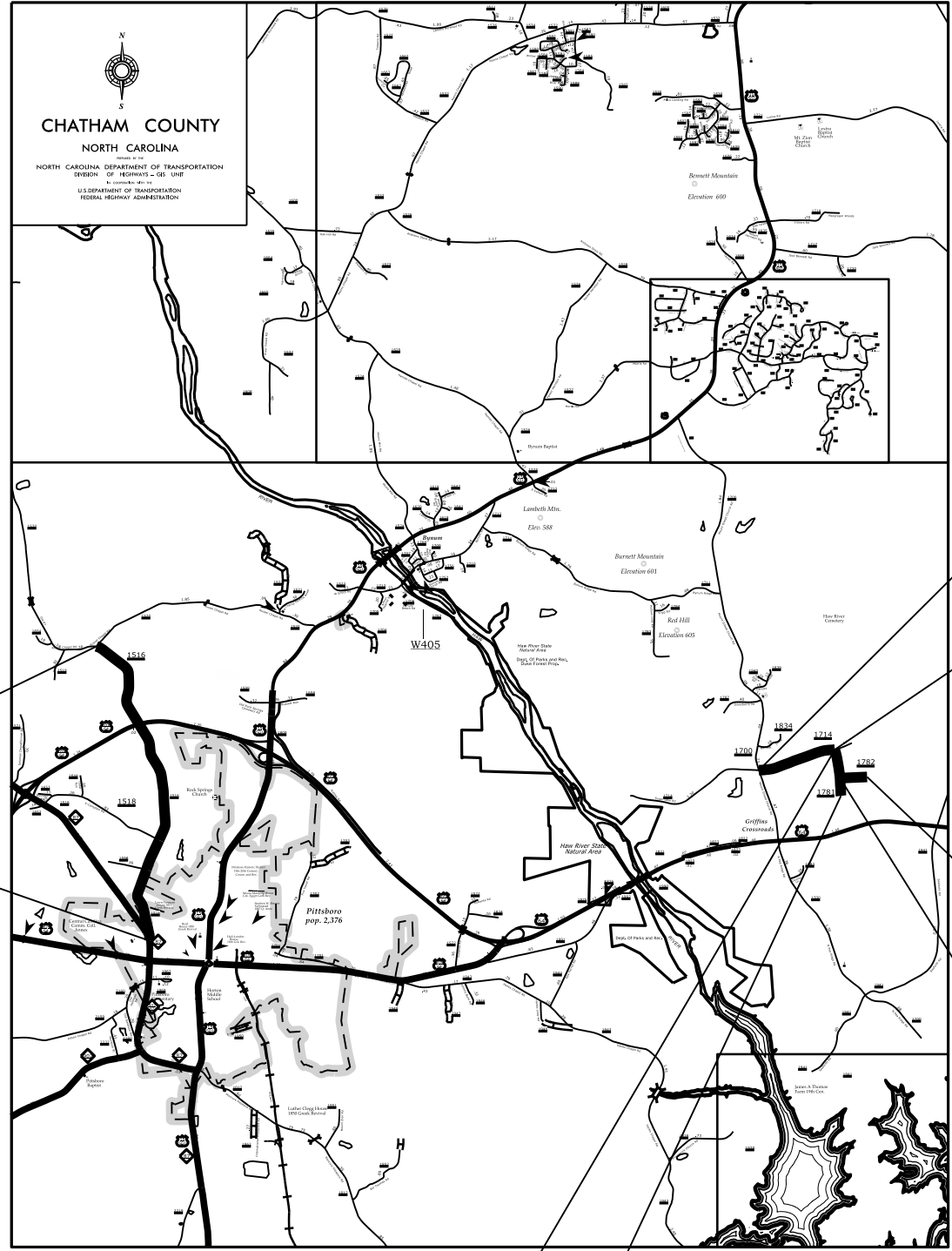

38

12

14

13

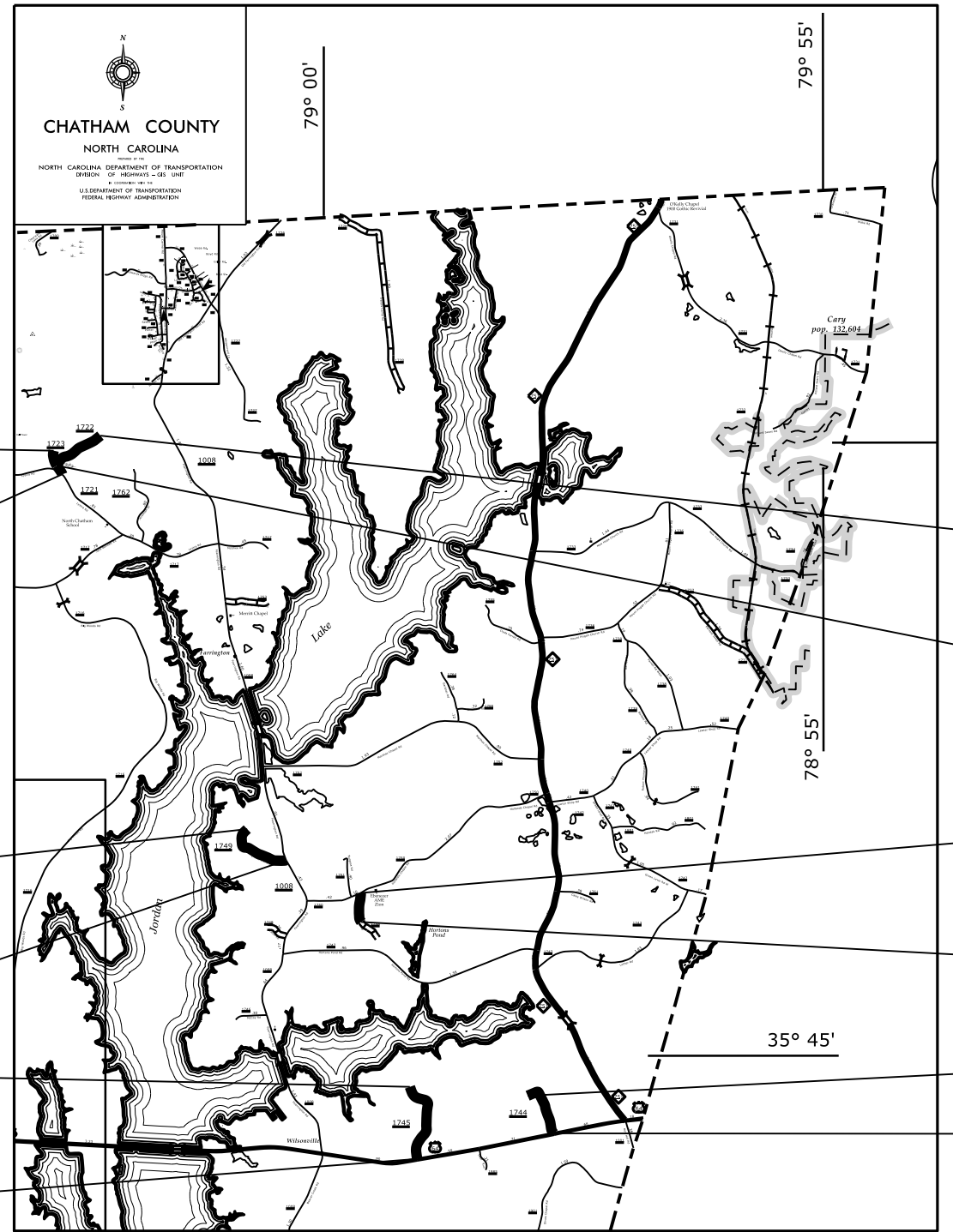

16

19

18

15

20

17

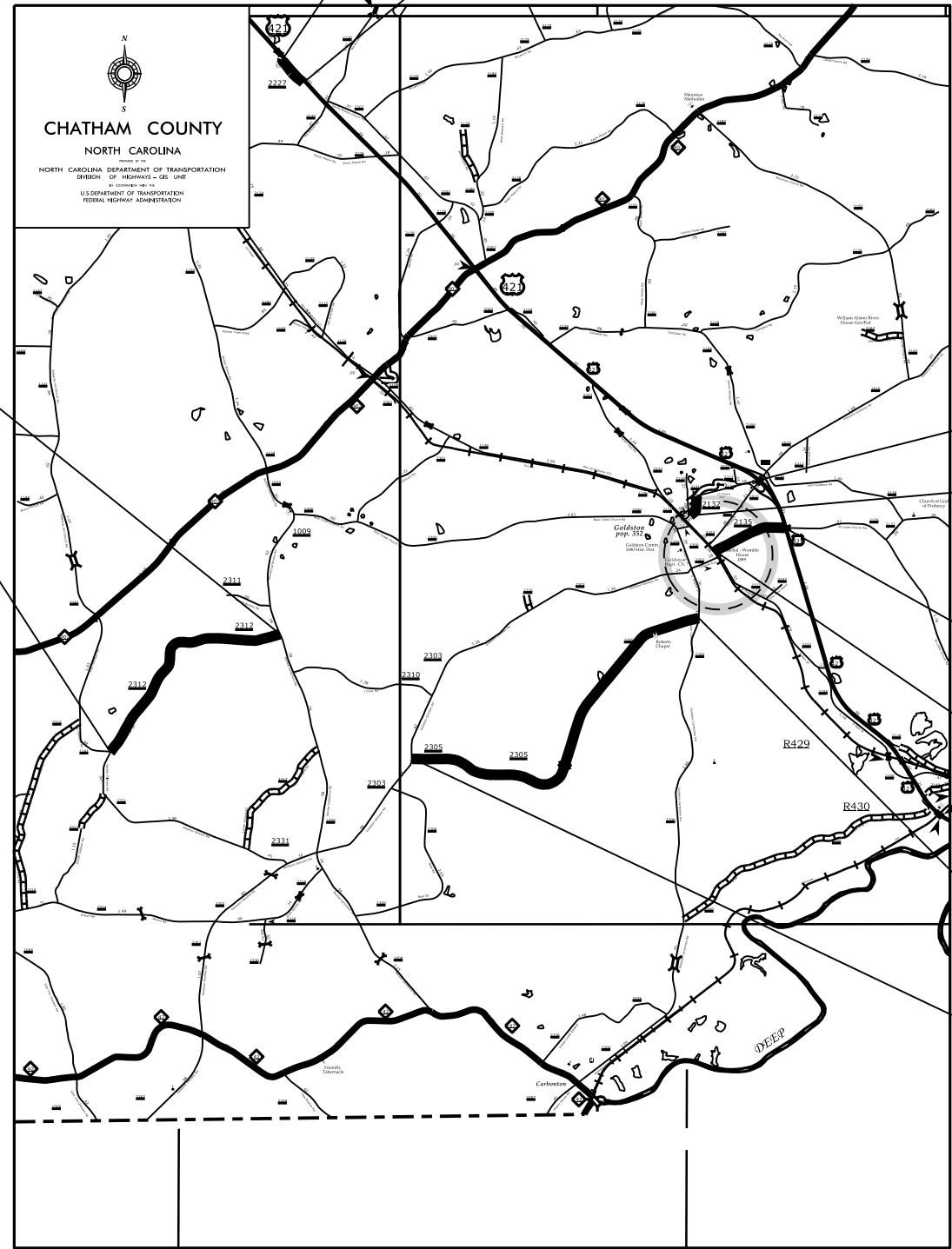
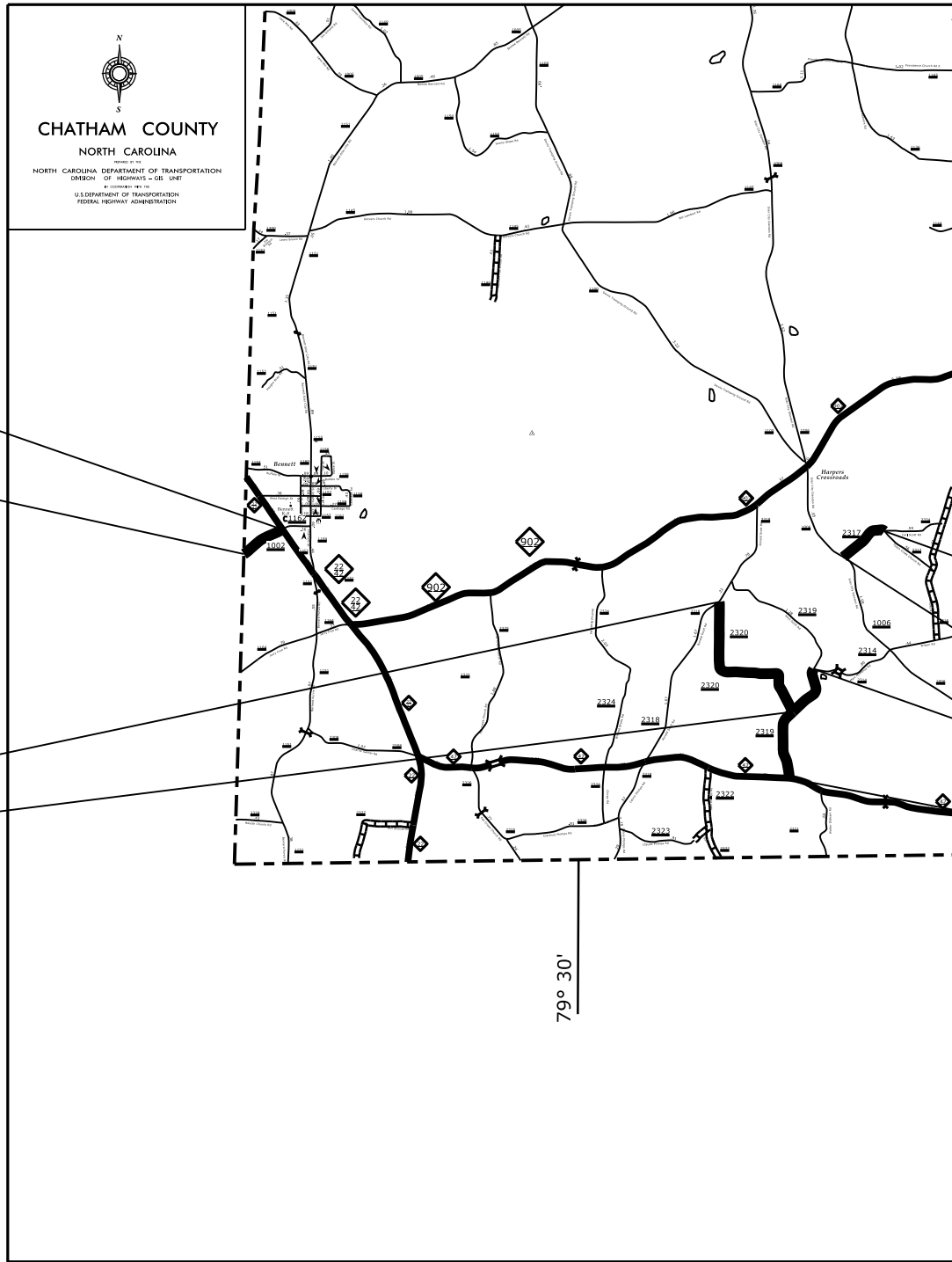

32

31

29

30

28

26

22

34

27

- 1) NEW HOPE OVERLOOK - MAPS 39-41
- 2) EBENEZER - MAPS 42-47
- 3) POPLAR POINT - MAPS 48-59
- 4) CROSSWINDS CAMPGROUND - MAPS 60-66
- 5) ROBENSON CREEK - MAPS 67
- 6) SEAFORTH - MAPS 68-71
- 7) PARKERS CREEK - MAPS 72-77
- 8) VISTA POINT - MAPS 78-82
- 9) WHITE OAK - MAPS 83

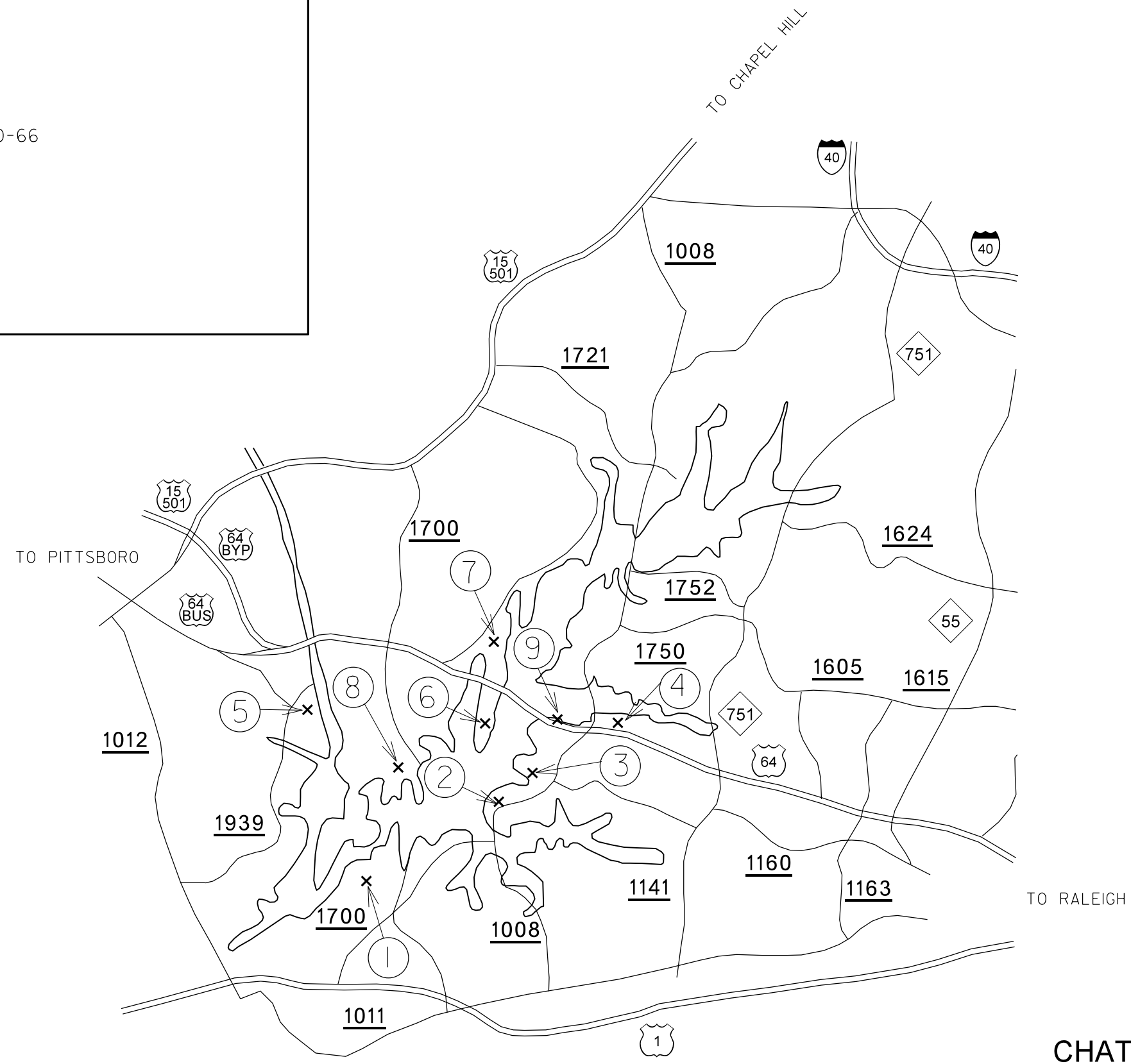

CHATHAM COUNTY
JORDAN LAKE PATCHING AND CRACK SEAL MAP

NEW HOPE OVERLOOK



TRAILS

Blue Trail 2.7 miles moderate

Red Trail 5.4 miles moderate
(Blue Trail is part of Red Trail)

*Day hikers must be off of the trail and out of the park by closing time, plan accordingly.

*Campers must camp in designated sites in camping areas A or B.

LEGEND

- Boat Launch
- Entrance Station
- Gate
- Hiking Trails
- Mulch toilet
- Parking
- Park Boundary
- Restrooms
- Roads - paved
- Roads - closed to vehicles
- Footpath
- Telephone

*Numbers represent campsites.

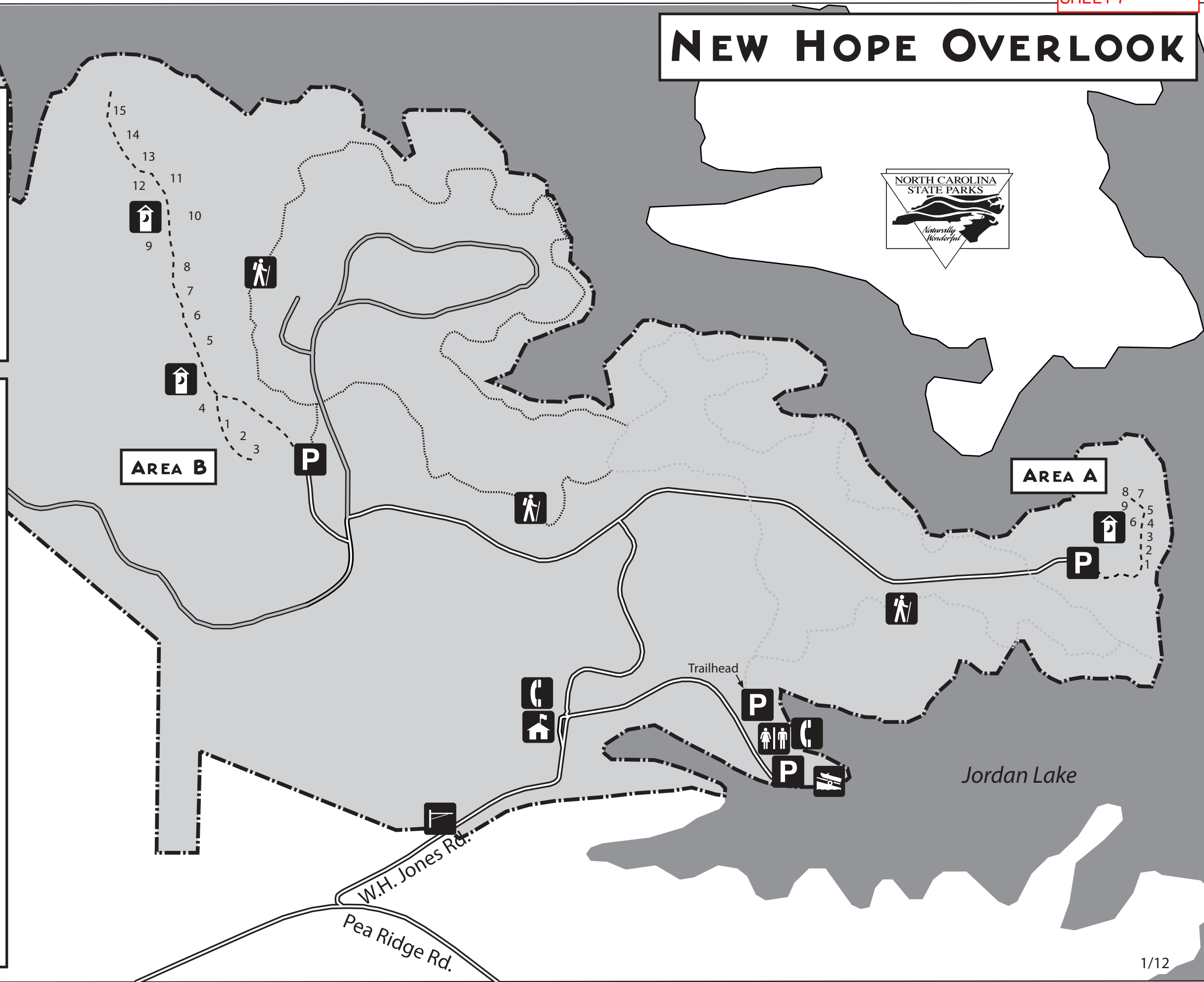

JORDAN LAKE STATE RECREATION AREA

EBENEZER CHURCH RECREATION AREA

280 State Park Road, Apex, NC 27523
GPS: 35.7084, -79.0164
jordan.lake@ncdemr.gov (919) 362-0586

SHEET 8

| TRAIL DISTANCE | |
|-----------------------|----------|
| Old Oak Trail | 1 Miles |
| Ebenezer Church Trail | 1 Miles |
| Connector Trail | .5 Miles |

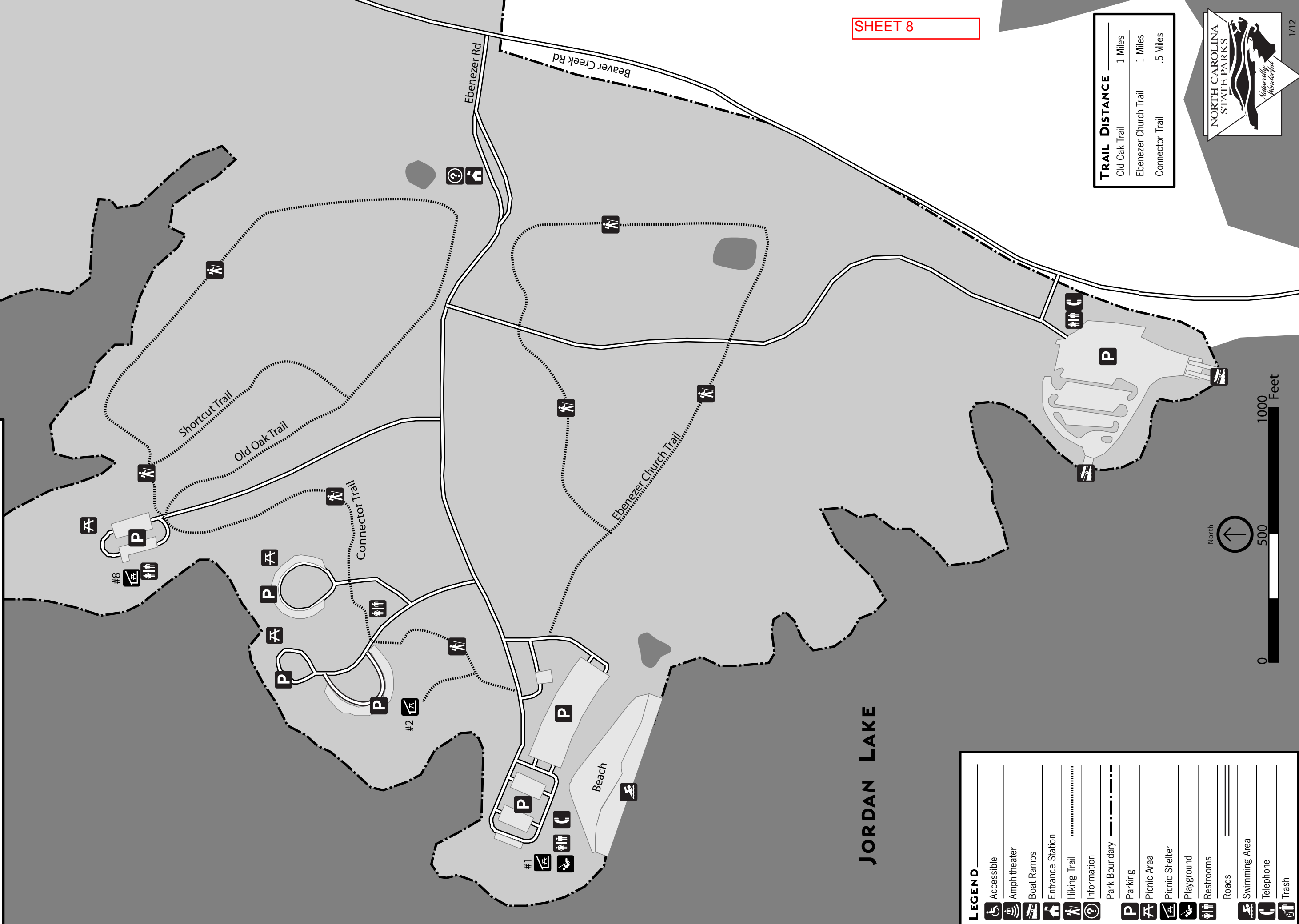

| LEGEND | |
|--------|------------------|
| | Accessible |
| | Amphitheater |
| | Boat Ramps |
| | Entrance Station |
| | Hiking Trail |
| | Information |
| | Park Boundary |
| | Parking |
| | Picnic Area |
| | Picnic Shelter |
| | Playground |
| | Restrooms |
| | Roads |
| | Swimming Area |
| | Telephone |
| | Trash |

JORDAN LAKE STATE RECREATION AREA

POPLAR POINT CAMPGROUND

280 State Park Road, Apex, NC 27523
GPS: 35.7291, -79.0042
jordan.lake@ncdenr.gov (919) 362-0586

LEGEND

- | | |
|-------------------------|---------------------------|
| Accessible | Parking |
| Amphitheatre | Playground |
| Bathroom | Recycling |
| Boat Ramps | Restrooms |
| Campsites non-electric | Roads |
| Campsites with Electric | Sanitary Disposal Station |
| Entrance Station | Swimming Area |
| Hiking Trail | Telephone |
| Information | Water Spigot |
| Park Boundary | |



JORDAN LAKE STATE RECREATION AREA

CROSSWINDS CAMPGROUND

280 State Park Road, Apex, NC 27523
 GPS: 35.7420, -79.0021
 jordan.lake@ncdenr.gov (919) 362-0586

LEGEND

- Accessible
- Amphitheater
- Bathhouse
- Boat Ramps
- Campsites
- Campsites with Electric & Water
- Campground Host
- Dump Station
- Duplex Campsite (double fee)
- Duplex Campsite with Electric & Water (double fee)
- Entrance Station
- Hiking Trail
- Information
- Park Boundary
- Parking
- Restrooms
- Roads
- Swimming Area
- Telephone
- Trash

WATERFRONT SITES:

Loop A: 19, 21, 22, 45, 46, 47
 Loop B: 36, 37, 39, 40, 43, 46
 Loop C: 12, 15, 19, 21, 23, 24, 26, 30, 32, 34, 36, 40, 42

JORDAN LAKE

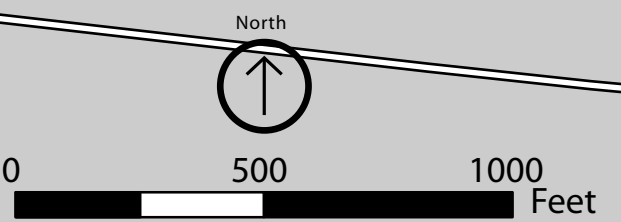
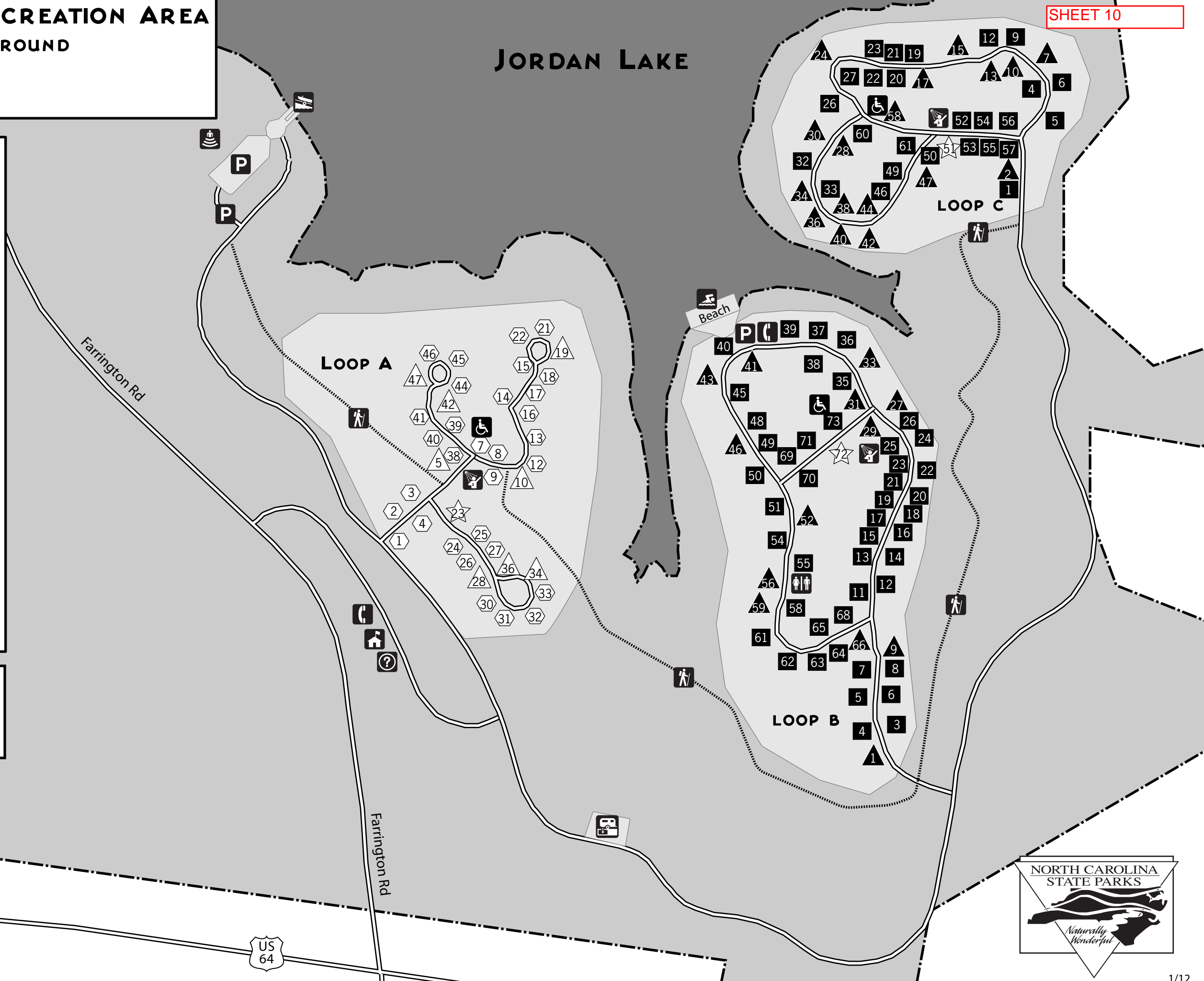

NO MAP FOR ROBESON CREEK AREA

JORDAN LAKE STATE RECREATION AREA

PARKERS CREEK CAMPGROUND

280 State Park Road, Apex, NC 27523
GPS: 35.7381, -79.0410
jordan.lake@ncdenr.gov (919) 362-0586

| LEGEND | |
|--------|--------------------------------|
| | Accessible |
| | Amphitheater |
| | Bathhouse |
| | Boat Ramps |
| | Campground Host |
| | Campsites |
| | Campsites - Electric and Water |
| | Entrance Station |
| | Group Campsites |
| | Hiking Trail |
| | Information |
| | Park Boundary |
| | Parking |
| | Picnic Shelter |
| | Restrooms |
| | Roads |
| | Sanitary Disposal Station |
| | Swimming Area |
| | Telephone |
| | Trash |

JORDAN LAKE



SHEET 12



US 64



JORDAN LAKE STATE RECREATION AREA

VISTA POINT CAMPGROUND

SHEET 13

GPS: -79.05928, 35.70960
jordan.lake@ncdenr.gov (919) 362-0586

LEGEND

- Boat Ramp
- Group Campsites
- Hiking Trail
- Park Boundary
- Park Gate
- Parking Area
- Entrance Station
- Picnic Shelter
- Restrooms
- Roads
- RV Group Camping
- RV Campsites with electric & water
- Sailboat Launch
- Sanitary Disposal Station
- Swimming Area
- Telephone
- Volleyball Area

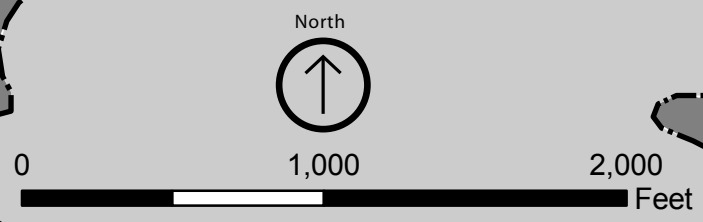
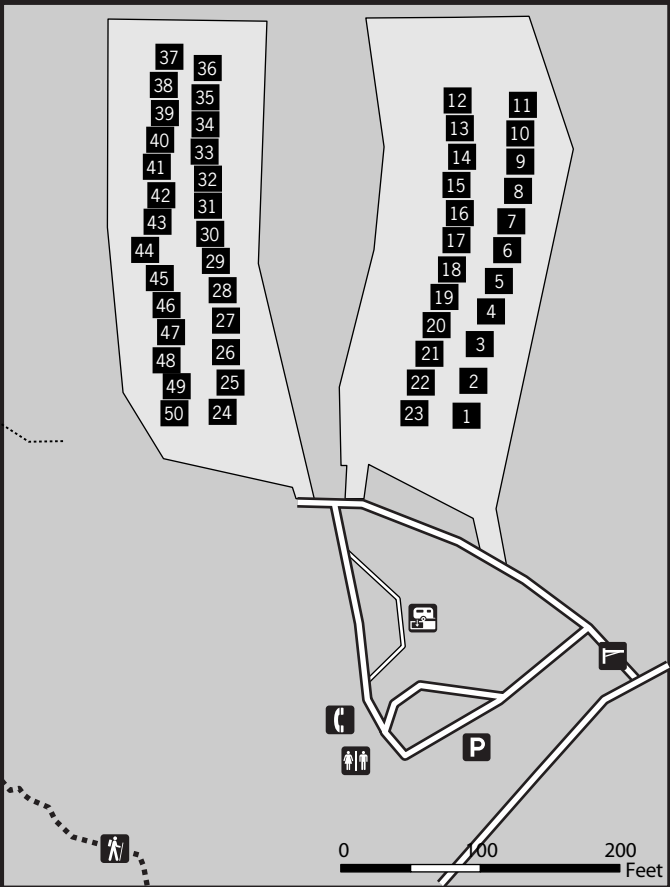
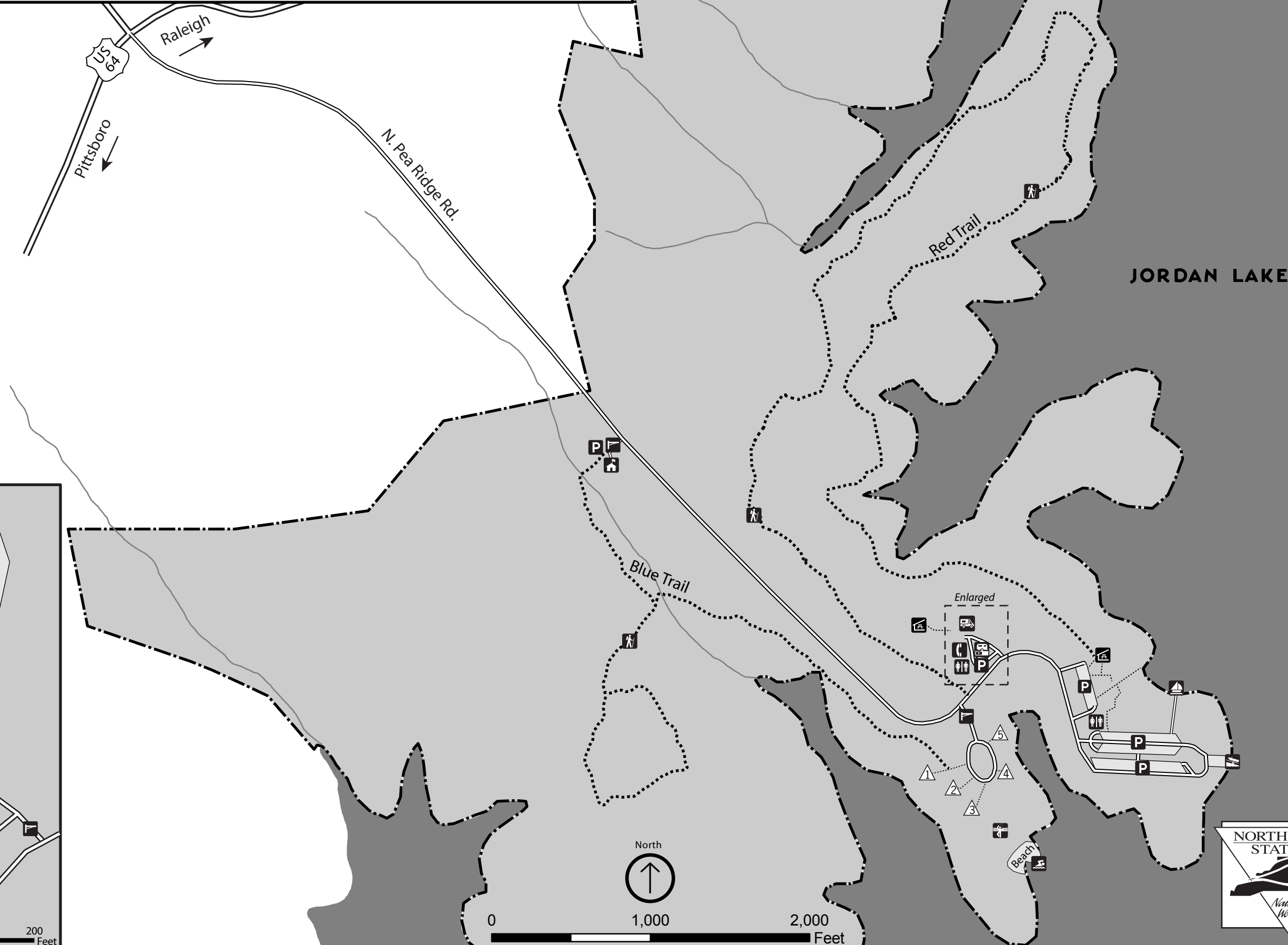

NO MAP FOR WHITE OAK AREA

| | | |
|--------------|-----------|-----------|
| PROJECT NO. | SHEET NO. | TOTAL NO. |
| 8SP.20194.15 | 15 | |
| 30001.23 | | |

SUMMARY OF QUANTITIES

| PROJECT NO | COUNTY | MAP NO | ROUTE | DESCRIPTION | TYP | LANES | LANE TYPE | FINAL SURFACE TESTING REQUIRED | WARM MIX ASPHALT REQUIRED | LENGTH MI | WIDTH FT | GENERIC GRADING ITEM - AGGREGATE SHOULDER BORROW | SHOULDER RECONSTRUCTION | SEALING EXISTING PAVEMENT CRACKS & JOINTS | PATCHING EXISTING PAVEMENT | ASPHALT SURFACE TREATMENT, DOUBLE SEAL | EMULSION FOR ASPHALT SURFACE TREATMENT | BLOTTING SAND | 4413000000-E | 4457000000-N | 4810000000-E | 4830000000-E | 4835000000-E | 4840000000-N | | |
|-----------------------------|---------|--------|----------------------------------|--|-----|-------|-----------|--------------------------------|---------------------------|-----------|----------|--|-------------------------|---|----------------------------|--|--|---------------|---|---------------------------|----------------|-----------------|-----------------|-----------------|---------------|---|
| | | | | | | | | | | | | | | | | | | | WORK ZONE ADVANCE/GENERAL WARNING SIGNING | TEMPORARY TRAFFIC CONTROL | 4" WHITE PAINT | 4" YELLOW PAINT | 16" WHITE PAINT | 24" WHITE PAINT | PAINT MSG RXR | |
| | | | | | | | | | | | | | | | | | | | SF | LS | LF | LF | LF | LF | EA | |
| 8SP.20194.15 | Chatham | 1 | SR 1119 (WADE PASCHAL RD) | FROM SR 1121 (SS EDWARDS RD) TO SR 1006 SILER CITY GLENDON RD | | 2 | | NO | NO | 0.806 | 18 | | | | | 8,520.00 | 4,690 | 50 | 91 | | | 17,350 | 17,350 | | | |
| TOTAL FOR MAP NO. 1 | | | | | | | | | | | | | | | | | | | | | | | | | | |
| 8SP.20194.15 | Chatham | 2 | SR 1169 (GRAHAM MOORE RD) | FROM SR 1101 (MOONS CHAPEL RD) TO MP 0.55 (365FT E OF IRENE LN) | | 2 | | NO | NO | 0.55 | 18 | | | | | 5,810.00 | 3,200 | | 62 | | | 11,840 | 11,840 | | | |
| TOTAL FOR MAP NO. 2 | | | | | | | | | | | | | | | | | | | | | | | | | | |
| 8SP.20194.15 | Chatham | 3 | SR 1312 (GRADY SILER RD) | FROM SR 1362 (PINEY GROVE CH RD) TO SR 1355 (R C OVERMAN RD) | | 2 | | NO | NO | 1.847 | 20 | | | | | 21,680.00 | 11,930 | | 207 | | | 39,750 | 39,750 | | | |
| TOTAL FOR MAP NO. 3 | | | | | | | | | | | | | | | | | | | | | | | | | | |
| 8SP.20194.15 | Chatham | 4 | SR 1106 (STOCKYARD RD) | FROM US 64 TO SR 1105 (BISH RD) | | 2 | | NO | NO | 1.74 | 20 | | | | | 20,420.00 | 11,240 | | 195 | | | 37,445 | 37,445 | | | |
| TOTAL FOR MAP NO. 4 | | | | | | | | | | | | | | | | | | | | | | | | | | |
| 8SP.20194.15 | Chatham | 5 | SR 1105 (BISH RD) | FROM SR 1106 (STOCKYARD RD) TO RXR .26MI S OF SR 1006 (OLD US 421) | | 2 | | NO | NO | 0.96 | 20 | | | | | 11,280.00 | 6,200 | | 79 | | | 20,660 | 20,660 | 50 | 25 | 2 |
| TOTAL FOR MAP NO. 5 | | | | | | | | | | | | | | | | | | | | | | | | | | |
| 8SP.20194.15 | Chatham | 6 | SR 1371 (UNITY POWERHOUSE CH RD) | FROM SR 1106 (STOCKYARD RD) TO END MAINTENANCE | | 2 | | NO | NO | 0.08 | 18 | | | | | 850.00 | 475 | | 9 | | | 1,725 | 1,725 | | | |
| TOTAL FOR MAP NO. 6 | | | | | | | | | | | | | | | | | | | | | | | | | | |
| 8SP.20194.15 | Chatham | 7 | SR 1372 (COLONIAL PARK RD) | FROM SR 1106 (STOCKYARD RD) TO END MAINTENANCE | | 2 | | NO | NO | 0.148 | 18 | | | | | 1,570.00 | 870 | | 166 | | | 3,185 | 3,185 | | | |
| TOTAL FOR MAP NO. 7 | | | | | | | | | | | | | | | | | | | | | | | | | | |
| 8SP.20194.15 | Chatham | 8 | SR 1373 (LOVES CREEK CH RD) | FROM US 64 TO END MAINTENANCE | | 2 | | NO | NO | 0.425 | 20 | | | | | 5,000.00 | 2,755 | | 48 | | | 9,150 | 9,150 | | | |
| TOTAL FOR MAP NO. 8 | | | | | | | | | | | | | | | | | | | | | | | | | | |
| 8SP.20194.15 | Chatham | 9 | SR 1506 (WHITE SMITH RD) | FROM SR 1557 (EPPS CLARK RD) TO SR 1555 (WOODY STORE RD) | | 2 | | NO | NO | 1.668 | 20 | | | | | 19,600.00 | 10,775 | | 187 | | | 35,900 | 35,900 | | | |
| TOTAL FOR MAP NO. 9 | | | | | | | | | | | | | | | | | | | | | | | | | | |
| 8SP.20194.15 | Chatham | 10 | SR 1549 (CASTLE ROCK FARM RD) | FROM SR 1559 (EMERSON COOK RD) TO SR 1558 (HENDERSON TANYARD RD) | | 2 | | NO | NO | 0.464 | 20 | | | | | 5,500.00 | 3,000 | | 52 | | | 9,990 | 9,990 | | | |
| TOTAL FOR MAP NO. 10 | | | | | | | | | | | | | | | | | | | | | | | | | | |
| 8SP.20194.15 | Chatham | 11 | SR 1558 (HENDERSON TANYARD RD) | FROM SR 1559 (EMERSON COOK RD) TO SR 1506 (WHITE SMITH RD) | | 2 | | NO | NO | 1.834 | 20 | | | | | 21,520.00 | 11,845 | | 206 | | | 39,470 | 39,470 | | | |
| TOTAL FOR MAP NO. 11 | | | | | | | | | | | | | | | | | | | | | | | | | | |
| 8SP.20194.15 | Chatham | 12 | SR 1714 (HATLEY RD) | FROM SR 1700 (MT GILEAD CH RD) TO END MAINTENANCE 0.17 MI E OF SR 1781 (JORDAN RD) | | 2 | | NO | NO | 0.734 | 20 | | | | | 10,610.00 | 5,845 | | 102 | | | 15,800 | 15,800 | | | |
| TOTAL FOR MAP NO. 12 | | | | | | | | | | | | | | | | | | | | | | | | | | |
| 8SP.20194.15 | Chatham | 13 | SR 1781 (TWIN LAKES DR) | FROM SR 1782 (JORDAN DR) TO END MAINT | | 2 | | NO | NO | 0.5 | 20 | | | | | 5,870.00 | 3,235 | | 57 | | | 10,760 | 10,760 | | | |
| TOTAL FOR MAP NO. 13 | | | | | | | | | | | | | | | | | | | | | | | | | | |
| 8SP.20194.15 | Chatham | 14 | SR 1782 (JORDAN DR) | FROM SR 1714 (HATLEY RD) TO END MAINT | | 2 | | NO | NO | 0.1 | 20 | | | | | 1,180.00 | 655 | | 12 | | | 2,155 | 2,155 | | | |
| TOTAL FOR MAP NO. 14 | | | | | | | | | | | | | | | | | | | | | | | | | | |
| 8SP.20194.15 | Chatham | 15 | SR 1722 (SAM JONES RD) | FROM SR 1721 (LYSTRA RD) TO END MAINTENANCE | | 2 | | NO | NO | 0.595 | 20 | | | | | 7,000.00 | 3,850 | | 67 | | | 12,805 | 12,805 | | | |
| TOTAL FOR MAP NO. 15 | | | | | | | | | | | | | | | | | | | | | | | | | | |
| 8SP.20194.15 | Chatham | 16 | SR 1723 (CARSON RD) | FROM SR 1722 (SAM JONES RD) TO END MAINTENANCE | | 2 | | NO | NO | 0.2 | 20 | | | | | 2,350.00 | 1,300 | | 23 | | | 4,305 | 4,305 | | | |
| TOTAL FOR MAP NO. 16 | | | | | | | | | | | | | | | | | | | | | | | | | | |
| 8SP.20194.15 | Chatham | 17 | SR 1744 (BOB HORTON RD) | FROM US 64 TO END MAINTENANCE | | 2 | | NO | NO | 0.498 | 20 | | | | | 5,850.00 | 3,225 | | 56 | | | 10,715 | 10,715 | | | |
| TOTAL FOR MAP NO. 17 | | | | | | | | | | | | | | | | | | | | | | | | | | |
| 8SP.20194.15 | Chatham | 18 | SR 1745 (JOHN HORTON RD) | FROM US 64 TO END MAINTENANCE | | 2 | | NO | NO | 0.8 | 20 | | | | | 9,400.00 | 5,175 | | 90 | | | 17,220 | 17,220 | | | |
| TOTAL FOR MAP NO. 18 | | | | | | | | | | | | | | | | | | | | | | | | | | |
| 8SP.20194.15 | Chatham | 19 | SR 1749 (E STONE RD) | FROM SR 1008 (FARRINGTON RD) TO END MAINTENANCE | | 2 | | NO | NO | 0.603 | 20 | | | | | 7,080.00 | 3,900 | | 68 | | | 12,980 | 12,980 | | | |
| TOTAL FOR MAP NO. 19 | | | | | | | | | | | | | | | | | | | | | | | | | | |
| 8SP.20194.15 | Chatham | 20 | SR 1758 (ALSTON RD) | FROM SR 1750 (HOLLANDS CHAPEL RD) TO END MAINTENANCE | | 2 | | NO | NO | 0.257 | 20 | | | | | 3,025.00 | 1,670 | | 29 | | | 5,530 | 5,530 | | | |
| TOTAL FOR MAP NO. 20 | | | | | | | | | | | | | | | | | | | | | | | | | | |
| 8SP.20194.15 | Chatham | 21 | SR 2113 (SAM FIELDS RD) | FROM PVT JT E OF EASTERN US 421 RAMP TO SR 2110 (ALSTON BRIDGE RD) | | 2 | | NO | NO | 1.896 | 20 | | | | | 22,250.00 | 12,245 | | 213 | | | 40,805 | 40,805 | | | |

| | | |
|--------------|-----------|-----------|
| PROJECT NO. | SHEET NO. | TOTAL NO. |
| 8SP.20194.15 | 17 | |
| 30001.23 | | |

SUMMARY OF QUANTITIES

| PROJECT NO | COUNTY | MAP NO | ROUTE | DESCRIPTION | TYP | LANES | LANE TYPE | FINAL SURFACE TESTING REQUIRED | WARM MIX ASPHALT REQUIRED | LENGTH MI | WIDTH FT | GENERIC GRADING ITEM - AGGREGATE SHOULDER BORROW | SHOULDER RECONSTRUCTION SMI | SEALING EXISTING PAVEMENT CRACKS & JOINTS LB | PATCHING EXISTING PAVEMENT TONS | ASPHALT SURFACE TREATMENT, DOUBLE SEAL SY | EMULSION FOR ASPHALT SURFACE TREATMENT GAL | BLOTTING SAND TON | 4413000000-E | 4457000000-N | 4810000000-E | | 4830000000-E | 4835000000-E | 4840000000-N | |
|--|---------|--------|----------------------------|-----------------------------------|-----|-------|-----------|--------------------------------|---------------------------|-----------|----------|--|-----------------------------|--|---------------------------------|---|--|-------------------|--|------------------------------|-------------------|--------------------|--------------------|--------------------|------------------|--|
| | | | | | | | | | | | | | | | | | | | WORK ZONE ADVANCE/GENERAL WARNING SIGNING SF | TEMPORARY TRAFFIC CONTROL LS | 4" WHITE PAINT LF | 4" YELLOW PAINT LF | 16" WHITE PAINT LF | 24" WHITE PAINT LF | PAINT MSG RXR EA | |
| TOTAL FOR PROJ NO. 30001.23 (NEW HOPE OVERLOOK) | | | | | | | | | | | | | | | | | | | | | | | | | | |
| 30001.23 (EBENEZER) | Chatham | 42 | MAIN ROAD | FROM SR 1108 TO BEACH PARKING LOT | | 2 | | NO | NO | 1 | 20 | | | 222.00 | 15 | | | | | 212 | | | | | | |
| TOTAL FOR MAP NO. 42 | | | | | | | | | | | | | | | | | | | | | | | | | | |
| 30001.23 (EBENEZER) | Chatham | 43 | BEACH PARKING | PARKING LOT AT BEACH | | 2 | | NO | NO | 0.08 | 20 | | | 1,183.00 | 15 | | | | | 9 | | | | | | |
| TOTAL FOR MAP NO. 43 | | | | | | | | | | | | | | | | | | | | | | | | | | |
| 30001.23 (EBENEZER) | Chatham | 44 | BOAT RAMP PARKING | | | 2 | | NO | NO | 0.08 | 20 | | | 390.00 | | | | | | 9 | | | | | | |
| TOTAL FOR MAP NO. 44 | | | | | | | | | | | | | | | | | | | | | | | | | | |
| 30001.23 (EBENEZER) | Chatham | 45 | ROAD TO THE BOAT RAMP | | | 2 | | NO | NO | 1 | 20 | 43.00 | 0.16 | 39.00 | | | | | | 212 | | | | | | |
| TOTAL FOR MAP NO. 45 | | | | | | | | | | | | | | | | | | | | | | | | | | |
| 30001.23 (EBENEZER) | Chatham | 46 | PICNIC AREA A PARKING | | | 2 | | NO | NO | 0.04 | 20 | | | 38.00 | | | | | | 5 | | | | | | |
| TOTAL FOR MAP NO. 46 | | | | | | | | | | | | | | | | | | | | | | | | | | |
| 30001.23 (EBENEZER) | Chatham | 47 | PICNIC AREA B | | | 2 | | NO | NO | 0.04 | 18 | 5.00 | 0.02 | | | | | | | 5 | | | | | | |
| TOTAL FOR MAP NO. 47 | | | | | | | | | | | | | | | | | | | | | | | | | | |
| TOTAL FOR PROJ NO. 30001.23 (EBENEZER) | | | | | | | | | | | | | | | | | | | | | | | | | | |
| 30001.23 (POPLAR POINT) | Chatham | 48 | MAIN ROAD | GATE TO BEACH | | 2 | | NO | NO | 1 | 20 | 22.00 | 0.08 | 174.00 | 50 | | | | | 212 | | | | | | |
| TOTAL FOR MAP NO. 48 | | | | | | | | | | | | | | | | | | | | | | | | | | |
| 30001.23 (POPLAR POINT) | Chatham | 49 | BEACH PARKING | | | 2 | | NO | NO | 0.04 | 20 | | | 75.00 | | | | | | 5 | | | | | | |
| TOTAL FOR MAP NO. 49 | | | | | | | | | | | | | | | | | | | | | | | | | | |
| 30001.23 (POPLAR POINT) | Chatham | 50 | ROADS TO LOOPS F,G,H AND J | | | 2 | | NO | NO | 1 | 20 | 7.00 | 0.11 | | 56 | | | | | 212 | | | | | | |
| TOTAL FOR MAP NO. 50 | | | | | | | | | | | | | | | | | | | | | | | | | | |
| 30001.23 (POPLAR POINT) | Chatham | 51 | LOOP J | | | 2 | | NO | NO | 1 | 20 | | | 75.00 | 65 | | | | | 212 | | | | | | |
| TOTAL FOR MAP NO. 51 | | | | | | | | | | | | | | | | | | | | | | | | | | |
| 30001.23 (POPLAR POINT) | Chatham | 52 | LOOP H | | | 2 | | NO | NO | 1 | 20 | 9.00 | 0.03 | 41.00 | 39 | | | | | 212 | | | | | | |
| TOTAL FOR MAP NO. 52 | | | | | | | | | | | | | | | | | | | | | | | | | | |
| 30001.23 (POPLAR POINT) | Chatham | 53 | LOOP G | | | 2 | | NO | NO | 1 | 20 | 6.00 | | 75.00 | 3 | | | | | 212 | | | | | | |
| TOTAL FOR MAP NO. 53 | | | | | | | | | | | | | | | | | | | | | | | | | | |
| 30001.23 (POPLAR POINT) | Chatham | 54 | LOOP F | | | 2 | | NO | NO | 1 | 20 | 2.00 | 0.01 | 66.00 | 37 | | | | | 212 | | | | | | |
| TOTAL FOR MAP NO. 54 | | | | | | | | | | | | | | | | | | | | | | | | | | |
| 30001.23 (POPLAR POINT) | Chatham | 55 | BOAT AMPHITHEATER PARKING | | | 2 | | NO | NO | 0.08 | 20 | 15.00 | 0.06 | 795.00 | | | | | | 9 | | | | | | |
| TOTAL FOR MAP NO. 55 | | | | | | | | | | | | | | | | | | | | | | | | | | |
| 30001.23 (POPLAR POINT) | Chatham | 56 | LOOP E | | | 2 | | NO | NO | 1 | 20 | 31.00 | 0.12 | 128.00 | 4 | | | | | 212 | | | | | | |
| TOTAL FOR MAP NO. 56 | | | | | | | | | | | | | | | | | | | | | | | | | | |
| 30001.23 (POPLAR POINT) | Chatham | 57 | LOOP C | | | 2 | | NO | NO | 1 | 20 | 20.00 | 0.08 | 21.00 | 21 | | | | | 212 | | | | | | |
| TOTAL FOR MAP NO. 57 | | | | | | | | | | | | | | | | | | | | | | | | | | |
| 30001.23 (POPLAR POINT) | Chatham | 58 | DUMP STATION | | | 2 | | NO | NO | 0.01 | 20 | | | 15.00 | 14 | | | | | 1 | | | | | | |
| TOTAL FOR MAP NO. 58 | | | | | | | | | | | | | | | | | | | | | | | | | | |
| 30001.23 (POPLAR POINT) | Chatham | 59 | LOOP B | | | 2 | | NO | NO | 1 | 20 | 21.00 | 0.08 | 347.00 | 63 | | | | | 212 | | | | | | |
| TOTAL FOR MAP NO. 59 | | | | | | | | | | | | | | | | | | | | | | | | | | |
| TOTAL FOR PROJ NO. 30001.23 (POPLAR POINT) | | | | | | | | | | | | | | | | | | | | | | | | | | |
| 30001.23 (CROSSWINDS CG) | Chatham | 60 | MAIN ROAD | FROM SR 1008 TO T INTERSECTION | | 2 | | NO | NO | 1 | 20 | 50.00 | 0.19 | 15.00 | 22 | | | | | 212 | | | | | | |
| TOTAL FOR MAP NO. 60 | | | | | | | | | | | | | | | | | | | | | | | | | | |
| 30001.23 (CROSSWINDS CG) | Chatham | 61 | ROAD TO LOOP A - BOAT RAMP | | | 2 | | NO | NO | 1 | 20 | 43.00 | 0.16 | 192.00 | 33 | | | | | 212 | | | | | | |
| TOTAL FOR MAP NO. 61 | | | | | | | | | | | | | | | | | | | | | | | | | | |
| 30001.23 (CROSSWINDS CG) | Chatham | 62 | BOAT PARKING | | | 2 | | NO | NO | 1 | 20 | 1.00 | | 579.00 | 4 | | | | | 212 | | | | | | |
| TOTAL FOR MAP NO. 62 | | | | | | | | | | | | | | | | | | | | | | | | | | |
| 30001.23 (CROSSWINDS CG) | Chatham | 63 | LOOP A | | | 2 | | NO | NO | 1 | 20 | 44.00 | 0.17 | 186.00 | 13 | | | | | 212 | | | | | | |
| TOTAL FOR MAP NO. 63 | | | | | | | | | | | | | | | | | | | | | | | | | | |
| 30001.23 (CROSSWINDS CG) | Chatham | 64 | ROAD TO LOOP B AND C | | | 2 | | NO | NO | 1 | 20 | 120.00 | 0.45 | 1,121.00 | 106 | | | | | 212 | | | | | | |
| TOTAL FOR MAP NO. 64 | | | | | | | | | | | | | | | | | | | | | | | | | | |
| 30001.23 (CROSSWINDS CG) | Chatham | 65 | LOOP C | | | 2 | | NO | NO | 1 | 20 | 35.00 | 0.13 | 189.00 | 21 | | | | | 212 | | | | | | |
| TOTAL FOR MAP NO. 65 | | | | | | | | | | | | | | | | | | | | | | | | | | |
| 30001.23 (CROSSWINDS CG) | Chatham | 66 | LOOP B | | | 2 | | NO | NO | 1 | 20 | 123.00 | 0.47 | 165.00 | 12 | | | | | 212 | | | | | | |
| TOTAL FOR MAP NO. 66 | | | | | | | | | | | | | | | | | | | | | | | | | | |
| TOTAL FOR PROJ NO. 30001.23 (CROSSWINDS CG) | | | | | | | | | | | | | | | | | | | | | | | | | | |
| 30001.23 (ROBESON CREEK) | Chatham | 67 | BOAT PARKING | | | 2 | | NO | NO | 0.08 | 20 | | | 939.00 | 34 | | | | | 9 | | | | | | |
| TOTAL FOR MAP NO. 67 | | | | | | | | | | | | | | | | | | | | | | | | | | |
| TOTAL FOR PROJ NO. 30001.23 (ROBESON CREEK) | | | | | | | | | | | | | | | | | | | | | | | | | | |
| 30001.23 (SEAFORTH) | Chatham | 68 | MAIN ROAD | FROM HWY 64 TO BEACH PARKING | | 2 | | NO | NO | 1 | 20 | 27.00 | 0.10 | | 95 | | | | | 212 | | | | | | |
| TOTAL FOR MAP NO. 68 | | | | | | | | | | | | | | | | | | | | | | | | | | |
| 30001.23 (SEAFORTH) | Chatham | 69 | BEACH PARKING | | | 2 | | NO | NO | 0.08 | 20 | | | | 6 | | | | | 9 | | | | | | |

| | | |
|--------------|-----------|-----------|
| PROJECT NO. | SHEET NO. | TOTAL NO. |
| 8SP.20194.15 | 18 | |
| 30001.23 | | |

SUMMARY OF QUANTITIES

| PROJECT NO | COUNTY | MAP NO | ROUTE | DESCRIPTION | TYP | LANES | LANE TYPE | FINAL SURFACE TESTING REQUIRED | WARM MIX ASPHALT REQUIRED | LENGTH MI | WIDTH FT | GENERIC GRADING ITEM - AGGREGATE SHOULDER BORROW TON | SHOULDER RECONSTRUCTION SMI | SEALING EXISTING PAVEMENT CRACKS & JOINTS LB | PATCHING EXISTING PAVEMENT TONS | ASPHALT SURFACE TREATMENT, DOUBLE SEAL SY | EMULSION FOR ASPHALT SURFACE TREATMENT GAL | BLOTTING SAND TON | 4413000000-E | 4457000000-N | 4810000000-E | | 4830000000-E | 4835000000-E | 4840000000-N | | | | | | | | | | | | | | | | | | | | |
|--|---------|--------|----------------------|-------------|-----|-------|-----------|--------------------------------|---------------------------|-----------|----------|--|-----------------------------|--|---------------------------------|---|--|-------------------|--|------------------------------|-------------------|--------------------|--------------------|--------------------|------------------|--|--|------|--|-------|------|----------|-----|--|--|--|--|--|--|--|--|--|--|--|--|
| | | | | | | | | | | | | | | | | | | | WORK ZONE ADVANCE/GENERAL WARNING SIGNING SF | TEMPORARY TRAFFIC CONTROL LS | 4" WHITE PAINT LF | 4" YELLOW PAINT LF | 16" WHITE PAINT LF | 24" WHITE PAINT LF | PAINT MSG RXR EA | | | | | | | | | | | | | | | | | | | | |
| TOTAL FOR MAP NO. 69 | | | | | | | | | | | | | | | | | | | | 9 | | | | | | | | | | | | | | | | | | | | | | | | | |
| 30001.23 (SEAFORTH) | Chatham | 70 | ROAD TO BOAT RAMP | | | 2 | | NO | NO | 1 | 20 | 22.00 | 0.08 | | 142 | | | | | 212 | | | | | | | | | | | | | | | | | | | | | | | | | |
| TOTAL FOR MAP NO. 70 | | | | | | | | | | | | | | | | | | | | 212 | | | | | | | | | | | | | | | | | | | | | | | | | |
| 30001.23 (SEAFORTH) | Chatham | 71 | BOAT PARKING LOT | | | 2 | | NO | NO | 0.12 | 20 | | | 2,100.00 | | | | | | 14 | | | | | | | | | | | | | | | | | | | | | | | | | |
| TOTAL FOR MAP NO. 71 | | | | | | | | | | | | | | | | | | | | 14 | | | | | | | | | | | | | | | | | | | | | | | | | |
| TOTAL FOR PROJ NO. 30001.23 (SEAFORTH) | | | | | | | | | | | | | | | | | | | | 447 | | | | | | | | 2.2 | | 49.00 | 0.18 | 2,100.00 | 243 | | | | | | | | | | | | |
| 30001.23 (PARKERS CREEK) | Chatham | 72 | MAIN ROAD | | | 2 | | NO | NO | 1 | 20 | | | | 18 | | | | | 212 | | | | | | | | | | | | | | | | | | | | | | | | | |
| TOTAL FOR MAP NO. 72 | | | | | | | | | | | | | | | | | | | | 212 | | | | | | | | | | | | | | | | | | | | | | | | | |
| 30001.23 (PARKERS CREEK) | Chatham | 73 | ROAD TO AMPHITHEATRE | | | 2 | | NO | NO | 1 | 20 | | | | 56 | | | | | 212 | | | | | | | | | | | | | | | | | | | | | | | | | |
| TOTAL FOR MAP NO. 73 | | | | | | | | | | | | | | | | | | | | 212 | | | | | | | | | | | | | | | | | | | | | | | | | |
| 30001.23 (PARKERS CREEK) | Chatham | 74 | DUMP STATION | | | 2 | | NO | NO | 0.08 | 20 | 13.00 | 0.05 | | 9 | | | | | 9 | | | | | | | | | | | | | | | | | | | | | | | | | |
| TOTAL FOR MAP NO. 74 | | | | | | | | | | | | | | | | | | | | 9 | | | | | | | | | | | | | | | | | | | | | | | | | |
| 30001.23 (PARKERS CREEK) | Chatham | 75 | LOOP 1 | | | 2 | | NO | NO | 1 | 20 | 2.00 | 0.01 | | | | | | | 212 | | | | | | | | | | | | | | | | | | | | | | | | | |
| TOTAL FOR MAP NO. 75 | | | | | | | | | | | | | | | | | | | | 212 | | | | | | | | | | | | | | | | | | | | | | | | | |
| 30001.23 (PARKERS CREEK) | Chatham | 76 | LOOP 3 | | | 2 | | NO | NO | 1 | 20 | | | | 19 | | | | | 212 | | | | | | | | | | | | | | | | | | | | | | | | | |
| TOTAL FOR MAP NO. 76 | | | | | | | | | | | | | | | | | | | | 212 | | | | | | | | | | | | | | | | | | | | | | | | | |
| 30001.23 (PARKERS CREEK) | Chatham | 77 | GROUP CAMPING | | | 2 | | NO | NO | 1 | 20 | | | | 9 | | | | | 212 | | | | | | | | | | | | | | | | | | | | | | | | | |
| TOTAL FOR MAP NO. 77 | | | | | | | | | | | | | | | | | | | | 212 | | | | | | | | | | | | | | | | | | | | | | | | | |
| TOTAL FOR PROJ NO. 30001.23 (PARKERS CREEK) | | | | | | | | | | | | | | | | | | | | 1,069 | | | | | | | | 5.08 | | 15.00 | 0.06 | | 111 | | | | | | | | | | | | |
| 30001.23 (VISTA POINT) | Chatham | 78 | MAIN ROAD | | | 2 | | NO | NO | 1 | 20 | | | | 20 | | | | | 212 | | | | | | | | | | | | | | | | | | | | | | | | | |
| TOTAL FOR MAP NO. 78 | | | | | | | | | | | | | | | | | | | | 212 | | | | | | | | | | | | | | | | | | | | | | | | | |
| 30001.23 (VISTA POINT) | Chatham | 79 | CAMPING AREA | | | 2 | | NO | NO | 1 | 20 | | | | 5 | | | | | 212 | | | | | | | | | | | | | | | | | | | | | | | | | |
| TOTAL FOR MAP NO. 79 | | | | | | | | | | | | | | | | | | | | 212 | | | | | | | | | | | | | | | | | | | | | | | | | |
| 30001.23 (VISTA POINT) | Chatham | 80 | DUMP STATION | | | 2 | | NO | NO | 0.01 | 20 | | | | 4 | | | | | 1 | | | | | | | | | | | | | | | | | | | | | | | | | |
| TOTAL FOR MAP NO. 80 | | | | | | | | | | | | | | | | | | | | 1 | | | | | | | | | | | | | | | | | | | | | | | | | |
| 30001.23 (VISTA POINT) | Chatham | 81 | PICNIC PARKING | | | 2 | | NO | NO | 0.04 | 20 | | | | 23 | | | | | 5 | | | | | | | | | | | | | | | | | | | | | | | | | |
| TOTAL FOR MAP NO. 81 | | | | | | | | | | | | | | | | | | | | 5 | | | | | | | | | | | | | | | | | | | | | | | | | |
| 30001.23 (VISTA POINT) | Chatham | 82 | BOAT PARKING | | | 2 | | NO | NO | 0.08 | 20 | | | 150.00 | | | | | | 9 | | | | | | | | | | | | | | | | | | | | | | | | | |
| TOTAL FOR MAP NO. 82 | | | | | | | | | | | | | | | | | | | | 9 | | | | | | | | | | | | | | | | | | | | | | | | | |
| TOTAL FOR PROJ NO. 30001.23 (VISTA POINT) | | | | | | | | | | | | | | | | | | | | 439 | | | | | | | | 2.13 | | | | 150.00 | 52 | | | | | | | | | | | | |
| 30001.23 (WHITE OAK) | Chatham | 83 | PARKING | | | 2 | | NO | NO | 0.08 | 20 | | | 300.00 | | | | | | 9 | | | | | | | | | | | | | | | | | | | | | | | | | |
| TOTAL FOR MAP NO. 83 | | | | | | | | | | | | | | | | | | | | 9 | | | | | | | | | | | | | | | | | | | | | | | | | |
| TOTAL FOR PROJ NO. 30001.23 (WHITE OAK) | | | | | | | | | | | | | | | | | | | | 9 | | | | | | | | | | | | | | | | | | | | | | | | | |
| GRAND TOTAL | | | | | | | | | | 70.191 | | 665.00 | 2.56 | 10,991.00 | 1,048 | 483,385.00 | 253,565 | 50 | 10,646 | *1 | 885,650 | 885,650 | 50 | 25 | 2 | | | | | | | | | | | | | | | | | | | | |
| 1,771,300 | | | | | | | | | | | | | | | | | | | | | | | | | | | | | | | | | | | | | | | | | | | | | |

SIGNING FOR ASPHALT SURFACE TREATMENT

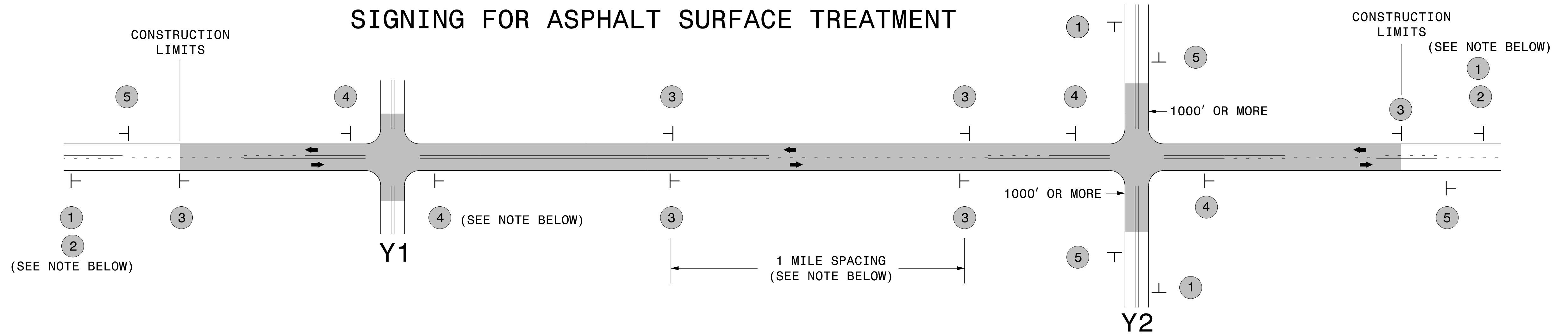

| LEGEND | |
|--------|---------------------------|
| | STATIONARY SIGN |
| ← | DIRECTION OF TRAFFIC FLOW |

MAINLINE (-L-) SIGNING

-Y- LINE SIGNING

| SIGNING NOTES AND PLACEMENT PER DIRECTION | | |
|--|--|--|
| 1 2 | <p>PLACE 1000' PRIOR TO BEGINNING OF CONSTRUCTION LIMITS. ONLY USED ON -Y- LINES IF RESURFACING LIMITS EXTEND 1000' ALONG -Y- LINE.</p> <p>#2 SIGN ONLY USED WHEN RESURFACING LIMITS ARE 2 OR MORE MILES IN LENGTH. ROUND UP TO NEXT WHOLE NUMBER. (NO FRACTIONAL OR DECIMAL NUMBERS)</p> | <p>NO REQUIRED STATIONARY SIGNING FOR THE FOLLOWING -Y- LINE CONDITIONS:</p> <ol style="list-style-type: none"> 1) LESS THAN 1000' OF RESURFACING ALONG -Y- LINE 2) SUBDIVISION ROADS 3) DEAD END ROADS |
| 3 | <p>ALTERNATE THE FOLLOWING TWO SIGNS: STARTING WITH "LOOSE GRAVEL" (W8-7) FOLLOWED BY "UNMARKED PAVEMENT".</p> <p>PLACE INITIALLY AT THE CONSTRUCTION LIMITS AND SPACED 1 MILE APART THEREAFTER. IF NO -Y- LINES EXIST, PLACE 2ND SET 1/2 MILE FROM THE CONSTRUCTION LIMITS AND THEN SPACE 1 MILE THEREAFTER.</p> | <p>WHEN PAVING/CONSTRUCTION ACTIVITIES PROCEED ACROSS AN UNSIGNED -Y- LINE, ADVANCE WARNING PORTABLE SIGNS SHALL BE USED ALONG THE -Y- LINE AS SHOWN BELOW. REMOVE UPON COMPLETION OF WORK.</p> <p>PLACED 500' IN ADVANCE OF FLAGGER. PLACED 250' IN ADVANCE OF FLAGGER.</p> |
| 4 | <p>THESE ARE FOR -Y- LINES THAT ARE "THROUGH" ROADWAYS. DEAD END AND SUBDIVISION ROADS ARE NOT "THROUGH" ROADWAYS. INSTALL 500' +/- FROM EACH -Y- LINE APPROACH AS SHOWN ABOVE. FOR MULTIPLE -Y- LINES THAT ARE SEPARATED BY 0.25 MILES OR LESS, TREAT AS A SINGLE UNIT AND INSTALL WITHIN 500' OF EACH APPROACH. A MAXIMUM OF 2 SIGN SETS PER MILE. DO NOT INSTALL WHEN -Y- LINES ARE WITHIN 0.5 MILES FROM "END ROAD WORK" SIGN.</p> | |
| 5 | <p>PLACE 500' FOLLOWING THE END OF CONSTRUCTION LIMITS.</p> | |

| | |
|--|--|
| | <p>ADVANCE WARNING SIGNS FOR ASPHALT SURFACE TREATMENTS 2 LANE ROADWAYS</p> |
|--|--|

12/22/2014
 S:\TMU\WZTC\apps\work\zonegeneral\external\webpage\desres\resurfacing\resurfacing\advwarn_2Ln - AST.dgn
 User:rmgarrrett